

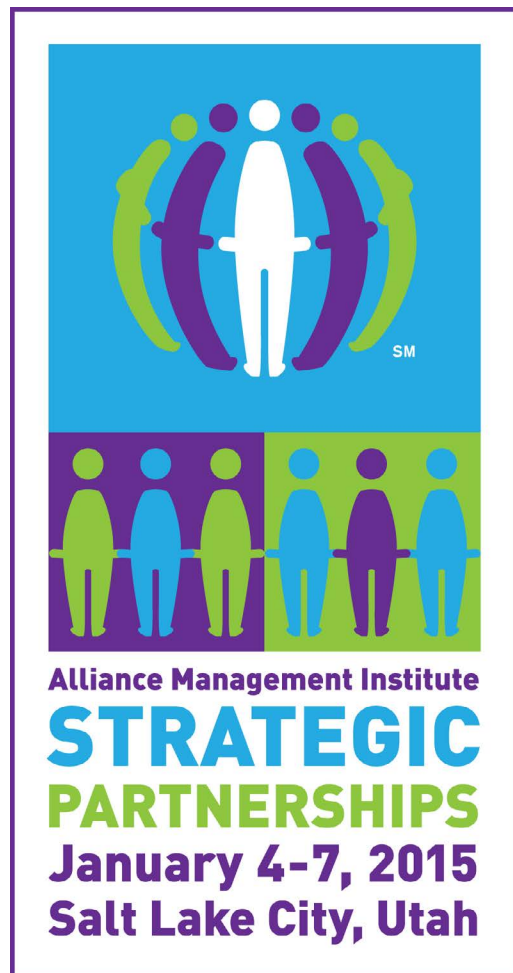

Certified to Change the World

The Nonprofit Leadership Alliance presents:
2015 Alliance Management Institute



Official Starter Kit

CONTENTS

About the Alliance Management Institute.....	3
AMI 2015 Theme.....	4
AMI 2015 in Salt Lake City.....	5
Travel Information.....	6
Registration.....	7
Tentative Schedule of Events.....	8
Program Overview.....	9
Informational Interviews.....	10
Student Advisory Council.....	11



Certified to Change the World

Nonprofit Leadership Alliance
1100 Walnut Street, Suite 1900
Kansas City, MO 64106
www.nonprofitleadershipalliance.org

ABOUT AMI

The Alliance Management Institute (AMI) is a capstone experience for students seeking the Certified Nonprofit Professional (CNP) credential. The purpose of the conference is to expose future social sector leaders to a vibrant learning experience that promotes best practices, innovative thinking and awareness of the full scope of the sector.

What can AMI do for you?

For Nonprofit Students

1. Fulfill the requirement for the Certified Nonprofit Professional (CNP) credential
2. Network with other nonprofit students and professionals

For Campus Directors

1. Connect with a group of peers for idea sharing
2. Grow the Nonprofit Leadership Alliance Student Network

For Professionals

1. Network with local, regional and national nonprofit leaders
2. Recruit emerging nonprofit professionals

For CNPs

1. Stay connected to the national Nonprofit Leadership Alliance network
2. Attend advanced workshops in the nonprofit field



Certified to Change the World

AMI is a memorable experience of learning, networking and sharing to support the advancement of the sector and its future leaders.

AMI 2015 THEME

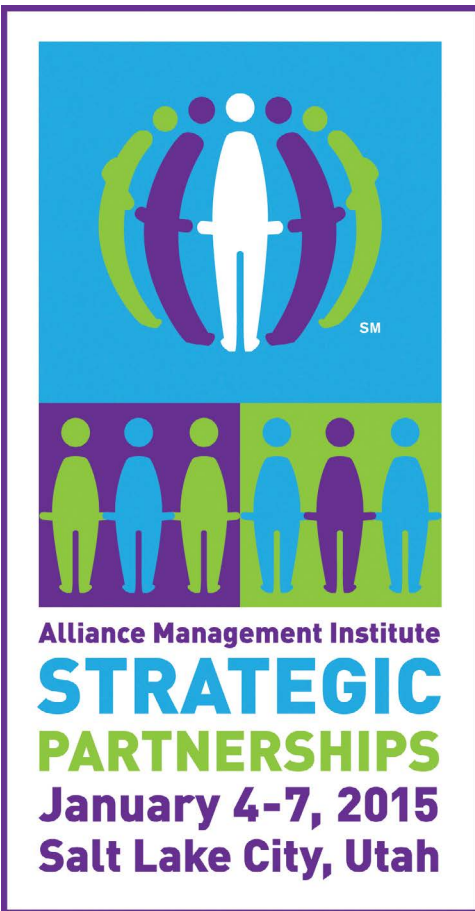

We know the drill: There is intense demand for the work of nonprofits – yet limited resources to go around. How do we make the most of those resources so that we can have the greatest impact in our communities?

The answer is
STRATEGIC PARTNERSHIPS.

Join us at AMI 2015 as we explore how innovative nonprofits are creating strategic alliances that help their organizations go farther, faster. Participants will learn about different partnership structures, how to vet potential partners and how you as nonprofit professionals can align your community assets – individuals, corporations, foundations and other nonprofits – to ensure your organization is getting results.



Partner with students, nonprofit professionals, and academic faculty
January 4-7, 2015 in Salt Lake City!

SALT LAKE CITY



AMI 2015 will be at the **Salt Palace Convention Center**. It is a modern facility capable of hosting a wide variety of events. Its S.O.A.R. initiative is an in-house program that reaches out to serve the community and protect the environment while focusing on safety and excellent service to its clients.

Attendees will be staying in the **Salt Lake City Marriott Downtown at City Creek**, just across the street and within walking distance of shopping, restaurants and nightlife. Also located in the heart of the city is **City Creek Mall**, SLC's premier shopping and dining destination, with 110 stores and restaurants.

The Nonprofit Leadership Alliance Welcomes You to Salt Lake City, Utah!

Ranks #1 in charitable contributions among metropolitan areas

45% of residents volunteer

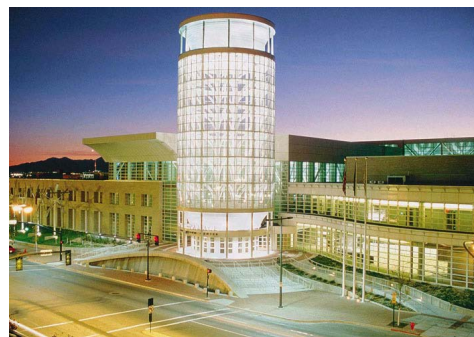

HOTEL ADDRESS

Salt Lake City Marriott Downtown
at City Creek
75 S West Temple
Salt Lake City, UT 84101



NEARBY SKIING

Park City	Brighton
Snowbird	Solitude
Alta	Sundance



SIGHTSEEING

Temple Square	The Great Salt Lake
LDS Humanitarian Center	Living Planet Aquarium
Hogle Zoo	Thanksgiving Point

TRAVEL INFORMATION

TRANSPORTATION OPTIONS

Plane: Salt Lake City International Airport

(Airport Code: SLC)

Train: Amtrak

(Salt Lake City- SLC; Address: 340 S 600 W,
Salt Lake City, UT 84101)

Bus: Greyhound

(Address: Salt Lake City Greyhound Station,
300 S 600 W, Salt Lake City, UT 84101)



HOTEL RESERVATIONS

The special AMI rate is
\$109/night, plus tax
(if made before 12/12/2014)

To reserve online: visit
<http://bit.ly/amihotelreservation>

To reserve by phone:
Call 1-801-531-0800 and
mention you are attending AMI

DIRECTIONS TO HOTEL*

From the Salt Lake City Airport:

Take the green line TRAX Rail at Airport Station heading to "West Valley;" Exit at Temple Square Station; Walk east on W South Temple, turn right on S West Temple to arrive at hotel

From the Amtrak Station:

Take the 701 Blue Line Train to Draper; Exit at Temple Square Station; Walk east on W South Temple, turn right on S West Temple to arrive at hotel

From the Greyhound Station:

Head south on S 600 W (toward W Broadway) to the Salt Lake Central Station; take the 701 Blue Line Train to Draper; Exit at Temple Square Station; Walk east on W South Temple, turn right on S West Temple to arrive at hotel

*Directions are given using public transportation



Certified to Change the World

REGISTRATION

1. In order to receive the discounted registration price, payment must be postmarked on or before the determined date.
2. All full conference registrations include dinner on Sunday, breakfast and lunch on Monday, and lunch and dinner on Tuesday.
3. Affiliated members include students and faculty from campus partners, national nonprofit partner professionals and CNPs.
4. All Monday-only registrations include breakfast and lunch.

	Early Registration Open through 10/24/14	Regular Registration 10/25/14 - 12/12/14	Late Registration 12/13/14 - 1/4/15
Affiliated Registration	\$325	\$375	\$450
Affiliated Members- Monday-Only	\$150	\$200	\$250
Non-Affiliated Students and Faculty	\$625	\$625	\$625
Community Members- Monday-Only	\$200	\$250	\$300
Opening Breakfast Ceremony	\$100	\$100	\$100
Closing Dinner Ceremony	\$100	\$100	\$100
EXPO Booth	\$1,000	\$1,000	\$1,000



Certified to Change the World

Registration opens
in the fall.
Watch for more
information!

TENTATIVE SCHEDULE

Alliance Management Institute (AMI) 2015 Tentative CNP Schedule

Sunday, January 4th

10 a.m.	Registration Opens
10 a.m.-12 p.m.	Informational Interviews*
10 a.m.-6 p.m.	Career and Resource EXPO
3 p.m.-5 p.m.	Quick-fire Sessions for Career Development
6 p.m.-8 p.m.	Networking Dinner Stations*
8 p.m.-9 p.m.	Yoga

Monday, January 5th

7:30 a.m.-6:30 p.m.	Career and Resource EXPO
8 a.m.-9:45 a.m.	Plenary and Breakfast with Case Study Hosts & Facilitators
10 a.m.-11:15 a.m.	Workshops: CNP Competencies – Round 1 (75mn)
11:30 a.m.-12:15 p.m.	Workshops: CNP Competencies – Round 2 (45mn)
12:15 p.m.-2:30 p.m.	Career and Resource EXPO Event
12:15 p.m.-2:30 p.m.	Lunch at Local Restaurants
1 p.m.-2:15 p.m.	Executive Committee meeting with all CNPs
2:30 p.m.-3:45 p.m.	Workshops: CNP Competencies – Round 3 (75mn)
4 p.m.-5:15 p.m.	Workshops: CNP Competencies – Round 4 (75mn)
4 p.m.-6:30 p.m.	Informational Interviews*
5:30 p.m.-6:30 p.m.	Poster Presentations*
6 p.m.-7:30 p.m.	CNP Networking Event
7:30 p.m.	Dinner-on-your-own and free evening to explore Salt Lake City

Tuesday, January 6th

8 a.m.-10 a.m.	Morning Plenary
10 a.m.-5 p.m.	Case Study Experience*
6 p.m.-8 p.m.	Closing Dinner and Awards Ceremony*
8 p.m.	Closing Celebration

Wednesday, January 7th

8 a.m.-12 p.m.	Informational Interviews*
9:30 a.m.-11:30 a.m.	Student Leadership Session
1 2 p.m.	Conference End

*Indicates areas where CNPs can take a leadership role in student programming

For updated information visit: www.amiconference.org

PROGRAM OVERVIEW

Before you register, understand the program content of AMI: the sessions you will be attending and their relevance to the nonprofit sector. Below is a general overview to help you understand and register successfully.

Case Studies

The most highly rated component of AMI is the case study experience. Working as consultants, groups of CNP students fan out across the AMI host community to help nonprofits tackle strategic challenges. With input from the nonprofits, students discuss the challenges and propose solutions to the nonprofit's leadership.

Workshops

Students attend professional-level workshops grounded in the CNP competencies. They learn how to increase program effectiveness, engage communities, understand sector trends, strengthen accountability and develop their careers. Because workshops are taught by professionals, students learn skills that are directly applicable in today's nonprofit workplace.

Informational Interviews

AMI allows students and nonprofit professionals to participate in informational career development interviews and open position interviews with national nonprofit partners. During informational interviews, professionals will assess your resume and cover letter, as well as answer questions you may have about the interview process or their organizations. For more information, please see page 10.

Career and Resource EXPO

AMI provides our nonprofit partners with a "golden opportunity" to create awareness of their missions and career opportunities among more than 600 college students who are ready to begin their nonprofit sector careers. EXPO booths feature information about each organization's target population, programs and services. Campuses feature their student association activities and graduate programs.

Plenaries

In addition to networking with each other and nonprofit professionals in the field, students at AMI hear from the sector's most prominent leaders. At plenary sessions, all conference attendees are exposed to topics that help them further understand the nonprofit sector, as well as get fired-up to go out and change the world!

INFORMATIONAL INTERVIEWS

What are Informational Interviews?

The goal is to find out about organizations you are interested in. Ask current professionals working in various organizations about their experiences and gain insight on potential internships or jobs you may be applying for in the future. Meet nonprofit partners, have your resume reviewed and have fun!



Where can I sign up?

Sign up for your interview slots when you register for the conference

When are Informational Interviews?

Sunday, January 4th from
10 a.m.-12:30 p.m.

Monday, January 5th from
4 p.m.-6:30 p.m.

Wednesday, January 7th from
8 a.m.-12:00 p.m.

Benefits of Informational Interviews

- Learn more about the realities of working in a particular occupation
- Gain exposure to various nonprofit professions
- Focus career goals, polish communication skills, and gain confidence
- Discover careers you never knew existed
- Receive professional resume building advice
- Find insight in preparing for a particular career
- Gather ideas for internship and employment opportunities
- Get an inside look at an organization you may want to work for

*Interviews are only 20 minutes,
so come prepared and be on time.*



Questions? Email:

ami@nonprofitleadershipalliance.org

STUDENT ADVISORY COUNCIL

The Student Advisory Council (SAC) is a team of future CNPs from campuses across the Nonprofit Leadership Alliance network who support AMI planning. These leaders volunteer their time to make AMI a success. Thank you to our 2015 SAC!



Elizabeth "Cathy" Baker
Registration Manager
Rockhurst University



Jenna Baker
Workshops and Plenaries
Assistant
Brigham Young University



Sean Clancy
Workshops and Plenaries
Assistant
Brigham Young University



Makenzie Court
Workshops and Plenaries
Assistant
Brigham Young University



Alasdair (Kufre) Ekpenyong
Fundraising and Workshops
Assistant
Brigham Young University



Jillian Hicken
Lead Case Study Coordinator
Brigham Young University



Kelsey Mumm
Informational Interviews and
Expo Assistant
Missouri Valley College



Leah Simmons
Informational Interviews and
Expo Assistant
Missouri Valley College



Certified to Change the World



Emilee Wolfe
Communications and Poster
Presentations Assistant
Brigham Young University